



INSTALLATION GUIDE

2020+ FORD EXPLORER ST 3.0L BAFFLED OIL CATCH CAN
SKU: MMBCC-EST-20PBE

TABLE OF CONTENTS

- Pg 1** RESOURCES & CONTACT INFORMATION
- Pg 2** EXPLODED DIAGRAM & PARTS BREAKDOWN
- Pg 3** IMPORTANT SAFETY INFORMATION
 - TOOLS NEEDED
 - INSTALLATION TIME
 - INSTALLATION DIFFICULTY
 - INSTALLATION INSTRUCTIONS
- Pg 6** CARE & MAINTENANCE
 - DISPOSAL INSTRUCTIONS
 - WARRANTY INFORMATION

RESOURCES & CONTACT



CALL 1-877-GOMISHI

CUSTOMER SERVICE HOURS: MON-FRI 8:30AM-5:00PM EST



MISHIMOTO



GOMISHIMOTO



MISHIMOTO



WEBSITE

WWW.MISHIMOTO.COM



ENGINEERING BLOG

WWW.MISHIMOTO.COM/ENGINEERING

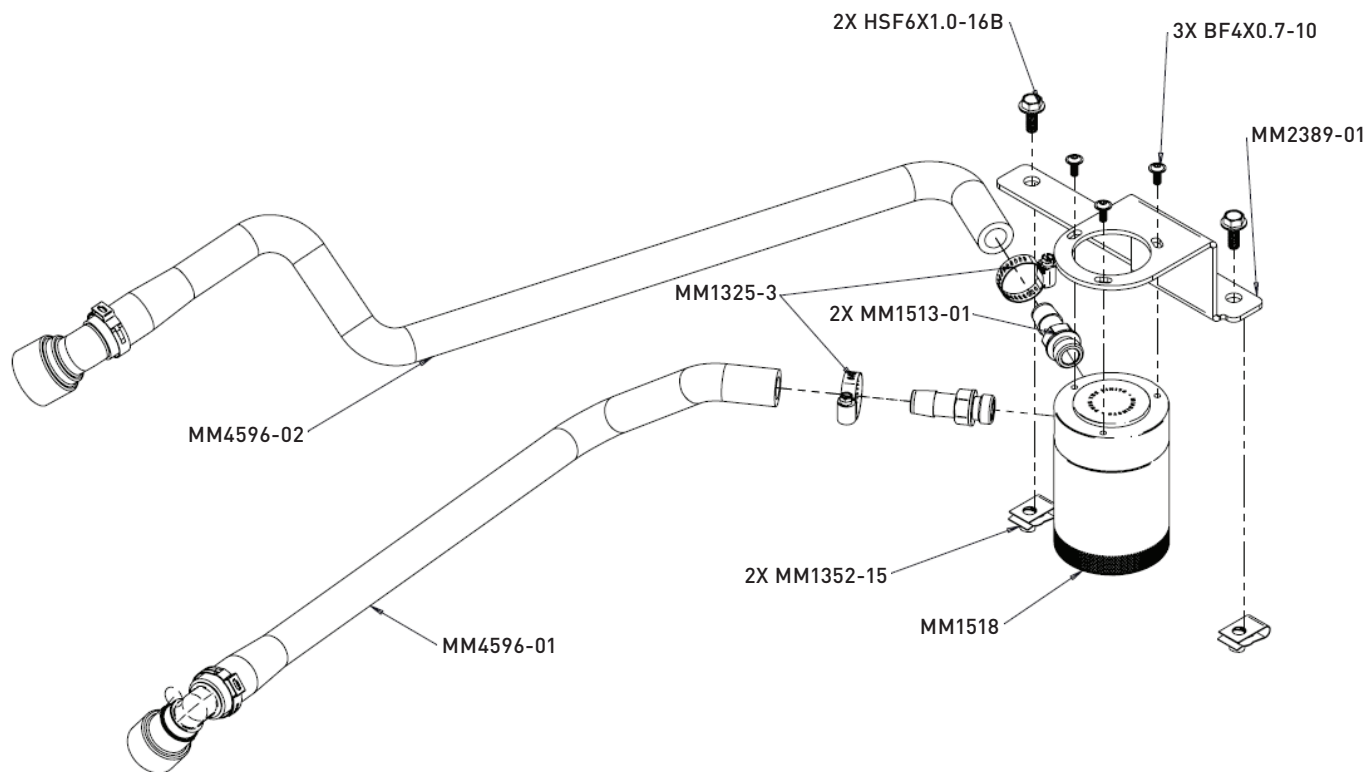

PARTS BREAKDOWN

PART NUMBER	DESCRIPTION	QUANTITY
MM1518	CATCH CAN	1
MM1513-01	FITTING	2
MM2389-01	BRACKET	1
MM4596-01	PCV TO CAN HOSE ASSEMBLY	1
MM4596-02	CAN TO MANIFOLD HOSE ASSEMBLY	1
MM1325-3	WORK GEAR HOSE CLAMP	2
HSF6X1.0-16B	M6 BOLT	2
MM1352-15	M6 NUT CLIP	2
BF4X0.7-10	M4 BOLT	3

IMPORTANT SAFETY INFORMATION

- Mishimoto recommends you use safety glasses and protective gloves during the installation of our products
- Raise vehicle only on jack stands or on a vehicle lift
- Allow vehicle to cool completely prior to attempting installation
- Do not run the engine or drive the vehicle while overheating; serious damage can occur
- Please dispose of any liquids properly
- Mishimoto is not responsible for any vehicle damage or personal injury due to installation errors, misuse, or removal of Mishimoto products
- If you need any assistance while installing our products, reach out to our Customer Service Team at 1-877-GOMISHI

TOOLS NEEDED

2.5MM ALLEN KEY/SOCKET

10MM 1/4"-DRIVE SOCKET

7MM 1/4"-DRIVE SOCKET OR FLATHEAD SCREWDRIVER

6" 1/4"-DRIVE EXTENSION

1/4" RATCHETING WRENCH AND/OR DRIVER

17MM WRENCH

INSTALLATION TIME 30 MINS

INSTALLATION DIFFICULTY     

INSTALLATION INSTRUCTIONS

- 01.** Remove factory PCV hose that connects intake manifold to PCV valve on passenger side valve cover by pushing outward on blue tab on each side and pulling the hose away from motor.



- 02.** Install two nut clips on the two tabs on the top passenger side of the fan shroud.

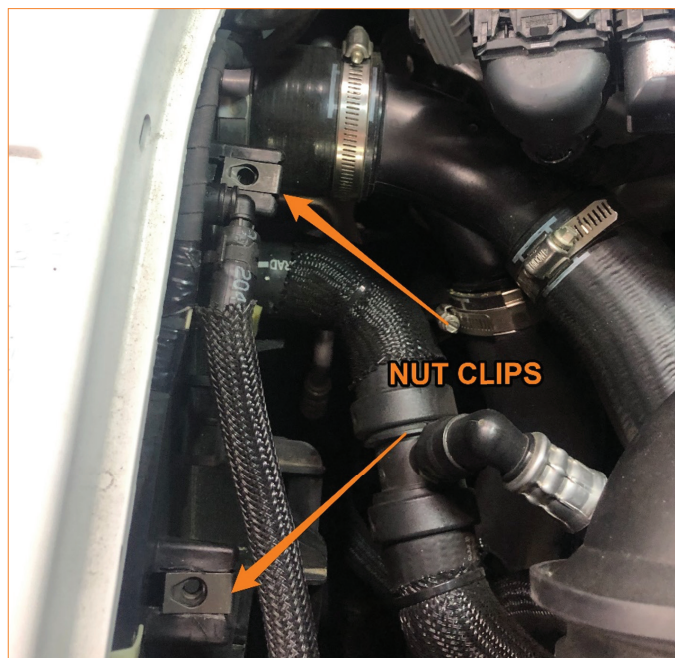

CONTINUED ON FOLLOWING PAGE

- 03.** Install bracket using the two provided M6 bolts and a 10mm socket. Be careful when tightening them as the nut clips are installed in plastic. We suggest torque of 3-4 N-m (2-3 lb/ft).

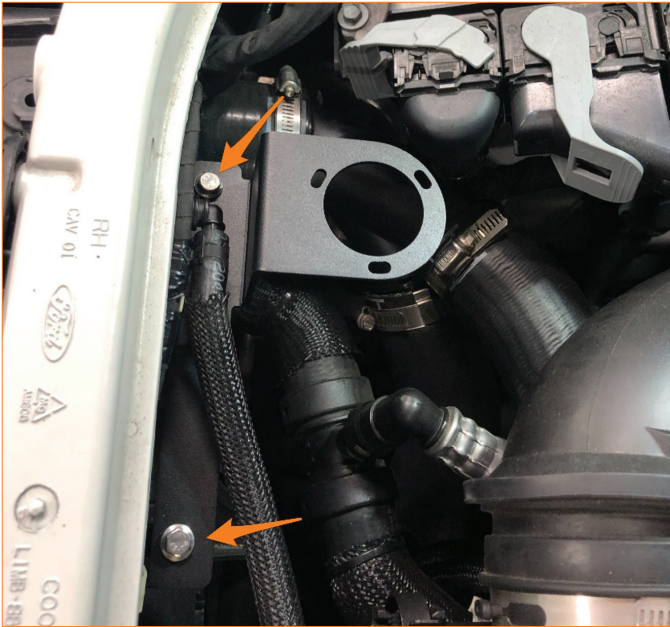

- 04.** Remove the 3X M4 allen-head screws from the catch can using a 2.5mm allen key. Install the two catch can fittings in the catch can using a 17mm wrench. Install the catch can on the bracket as shown, leaving the 3X allen head screws loose.

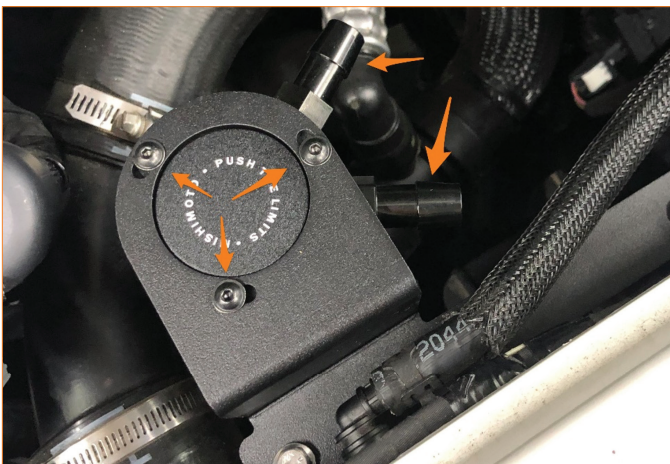

- 05.** Take the longer hose with the 45-degree fitting on it and connect the fitting side to the intake manifold, then route the hose underneath the intake tube. Connect to the "OUT" fitting on the catch can and secure with hose clamp. Verify that the hose is not rubbing on the intake tube. You may need to loosen the hose clamp and rotate the hose on the fitting to make sure that it has clearance away from the intake hose.



CONTINUED ON FOLLOWING PAGE

- 06.** Take the remaining hose and route underneath the wiring harness, then connect to the brown PCV fitting on the passenger-side valve cover. Push the green clip on the fitting to secure the locking mechanism. Route the hose underneath the intake tube and connect to the "IN" fitting on the catch can. Secure with hose clamp.

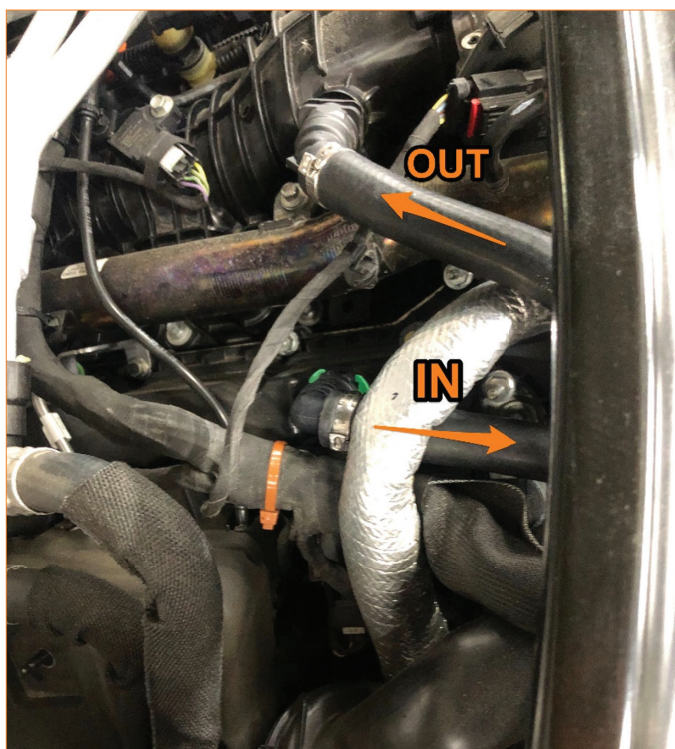

- 07.** Adjust the rotation of the catch can and tighten the 3X M4 allen bolts with a 2.5mm allen key.

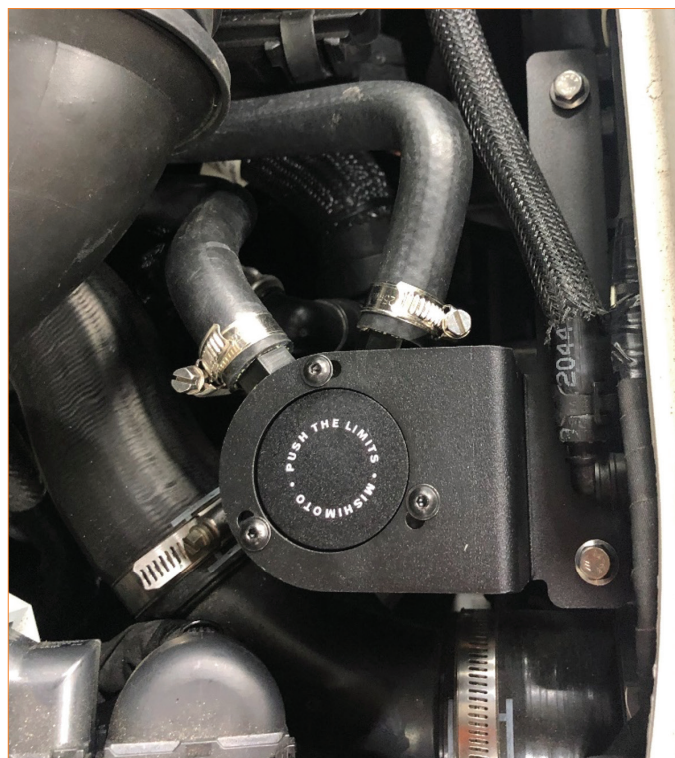

Congratulations! You have completed your installation.

***For Care & Maintenance, Disposal Instructions, and Warranty Information continue to the following page.**

CARE & MAINTENANCE

- › Drain catch can every 3,000 miles.
- › Inspect catch can kit every 10,000 miles for loose or worn components.

DISPOSAL INSTRUCTIONS

- › Do not dispose of any product as unsorted municipal waste. Use separate collection facilities. Contact your local authority for information regarding the collection systems available.
- › Never improperly dispose of any coolant, oil, or other chemicals.

WARRANTY INFORMATION



- › All claims must be accompanied with a picture of the Mishimoto product showing the issue for which the claim is being submitted.
- › Mishimoto asks that the customer inspect their purchased item for any damage immediately upon arrival.
- › Any product deemed dead on arrival (DOA) must be claimed within 14 business days of delivery. Claims outside of this time frame will not be covered under the Mishimoto Lifetime Warranty.
- › This warranty does not include payment and/or reimbursement of the cost of labor in connection with the removal of any product returned pursuant to the warranty policy or in connection with the installation of any replacement items provided under the warranty policy.

- › Mishimoto has the right to refuse a claim at any time.
- › When Mishimoto accepts a claim, Mishimoto retains full discretion to choose if it will: (i) repair or replace purchaser's original Mishimoto product; (ii) replace purchaser's original Mishimoto product with the most current available model; or (iii) provide the purchaser with a gift card redeemable on [Mishimoto.com](https://www.mishimoto.com) in the amount of the original purchase price of the original Mishimoto product. The provision of a replacement of a Mishimoto product is subject to availability and Mishimoto retains the right to substitute any warranty claim item with a comparable item or credit at any time.
- › If Mishimoto determines that it will provide a replacement item in connection with a claim under this warranty policy, and such item is out of stock, Mishimoto will place the customer on backorder and ship the replacement product to the purchaser once it becomes available.
- › Mishimoto is not liable for incorrect shipments in connection with a claim if a claim form is completed incorrectly, or if a model number is not included in a claim.
- › If you have a vehicle equipped with an automatic transmission, please make sure to specify this within the text box on the claim form. Mishimoto is not responsible for incorrect replacement shipments if transmission type is not indicated.



WARNING
Cancer and
Reproductive Harm
www.P65Warnings.ca.gov

This product can expose you to chemicals which are known to the state of California to cause cancer. For more information visit: www.p65warnings.ca.gov