



# INSTALLATION GUIDE

**2007-2010 BMW 335I CHARGE PIPE**

**SKU: MMICP-N54-07**

## TABLE OF CONTENTS

- Pg 1** RESOURCES AND CONTACT INFORMATION
- Pg 2** PARTS BREAKDOWN
- Pg 3** IMPORTANT SAFETY INFORMATION  
REQUIRED TOOLS  
INSTALLATION INSTRUCTIONS
- Pg 5** DISPOSAL INSTRUCTIONS  
WARRANTY INFORMATION

## RESOURCES & CONTACT

-  **CALL 1-877-GOMISHI**  
CUSTOMER SERVICE HOURS: MON-FRI 8:30AM-5:00PM EST
-  **MISHIMOTO**
-  **GOMISHIMOTO**
-  **MISHIMOTO**
-  **WEBSITE**  
[WWW.MISHIMOTO.COM](http://WWW.MISHIMOTO.COM)
-  **ENGINEERING BLOG**  
[WWW.MISHIMOTO.COM/ENGINEERING](http://WWW.MISHIMOTO.COM/ENGINEERING)

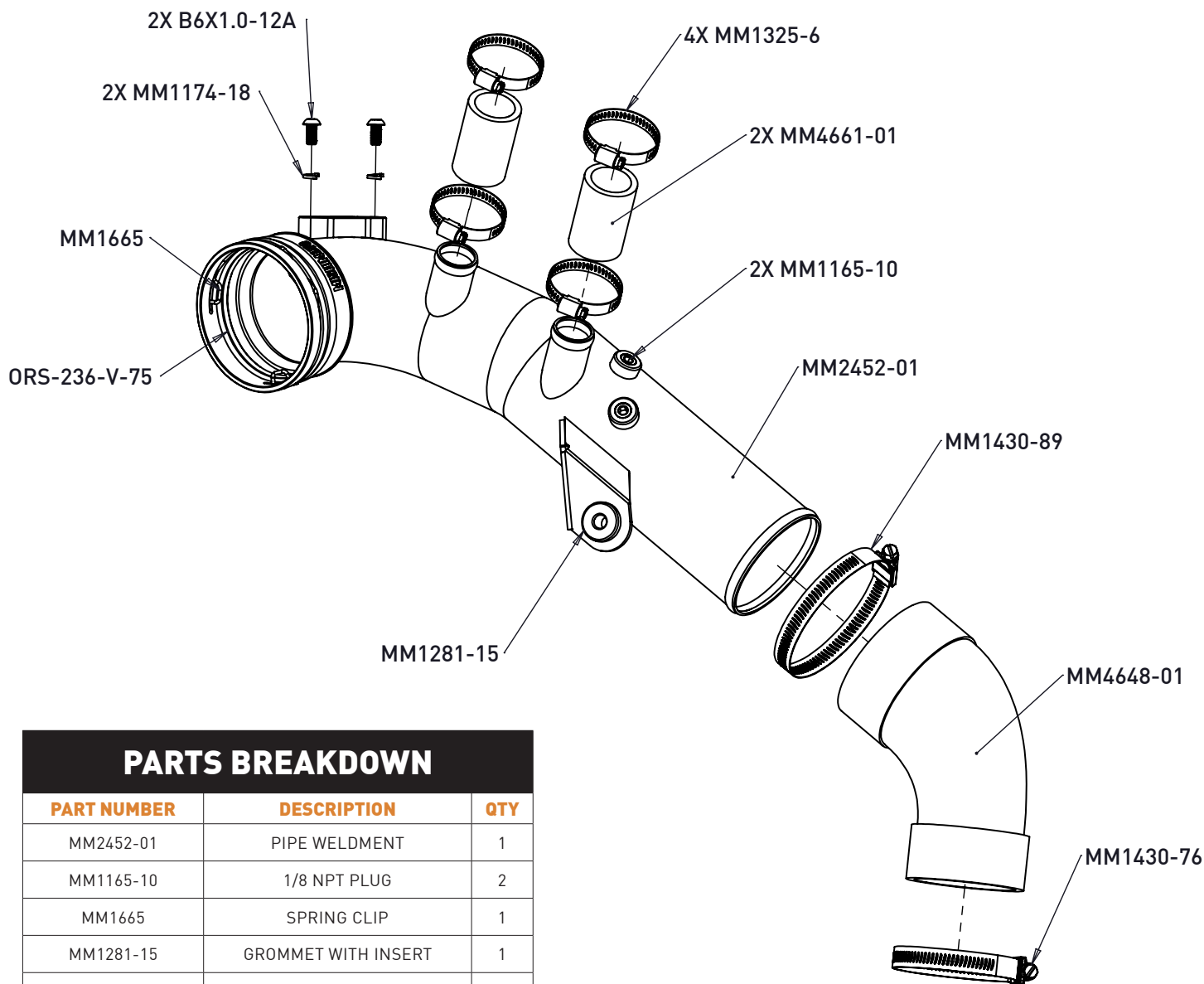

## PARTS BREAKDOWN

PART NUMBER	DESCRIPTION	QTY
MM2452-01	PIPE WELDMENT	1
MM1165-10	1/8 NPT PLUG	2
MM1665	SPRING CLIP	1
MM1281-15	GROMMET WITH INSERT	1
ORS-236-V-75	-236 O-RING	1
MM1174-18	LOCK WASHER	2
B6X1.0-12A	M6 12MM BUTTON HEAD BOLT	2
MM4661-01	COUPLER	2
MM1325-6	30-45MM WORM GEAR CLAMP	4
MM4648-01	COUPLER	1
MM1430-76	52-76MM HIGH TORQUE WORM GEAR CLAMP	1
MM1430-89	65-89MM HIGH TORQUE WORM GEAR CLAMP	1

Continued on next page

### IMPORTANT SAFETY INFORMATION

- › Mishimoto recommends you use safety glasses and protective gloves during the installation of our products
- › Raise vehicle only on jack stands or on a vehicle lift
- › Allow vehicle to cool completely prior to attempting installation
- › Do not run the engine or drive the vehicle while overheating; serious damage can occur
- › Please dispose of any liquids properly
- › Mishimoto is not responsible for any vehicle damage or personal injury due to installation errors, misuse, or removal of Mishimoto products
- › If you need any assistance while installing our products, reach out to our Customer Service Team at 1-877-GOMISHI

### REQUIRED TOOLS

SMALL PICK TOOL	6MM SOCKET
4MM ALLEN WRENCH	7MM SOCKET
T20 TORX	8MM SOCKET
T30 TORX	10MM SOCKET
¼" RATCHET	

**INSTALL TIME: 2 HOUR**

**INSTALL DIFFICULTY:** 

### NOTES

To avoid potential injury, wait for the engine to cool off before beginning installation.

### INSTALLATION INSTRUCTIONS

1. Remove the stock charge pipe from the vehicle.
2. Remove the pressure sensor (A) from the stock charge pipe and install it into the Mishimoto pipe using the provided M6 hardware. Use a 5mm Allen wrench to verify the 2x NPT plugs (B) are tight.

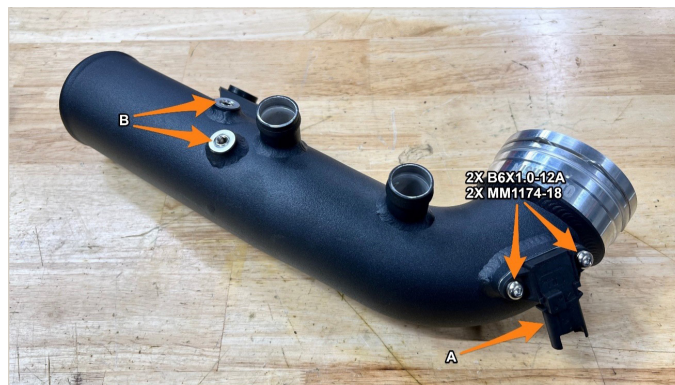

3. Install the 2x small straight couplers onto the pipe and use an 8mm socket to secure them with two 45mm worm gear clamps.
4. Install the large coupler over the end of the pipe as shown then slide the 89mm worm gear clamp over the coupler and loosely tighten it with an 8mm socket. Slide the 76mm worm gear clamp over the coupler, but do not tighten it yet.

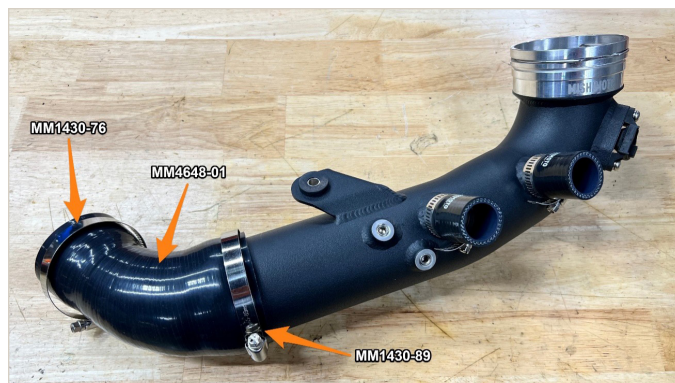

5. Install the charge pipe assembly into the vehicle throttle body side first. Push the pipe into the quick-disconnect fitting until you hear the clip snap into place.

Continued on next page



**6.** Rotate the angled coupler (A) until it lines up with the stock charge pipe (B), then push it on. Use an 8mm socket to tighten both worm gear clamps.

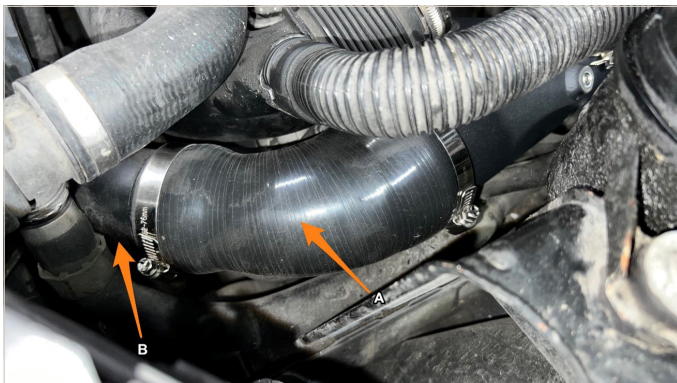

**7.** Using a 10mm socket, fasten the pipe bracket to the mount on the engine with the provided 6mm bolt. Slide two of the 45mm worm gear clamps onto the straight couplers, then push the stock recirculation valves into the couplers (B). Use an 8mm socket to tighten the worm gear clamps.

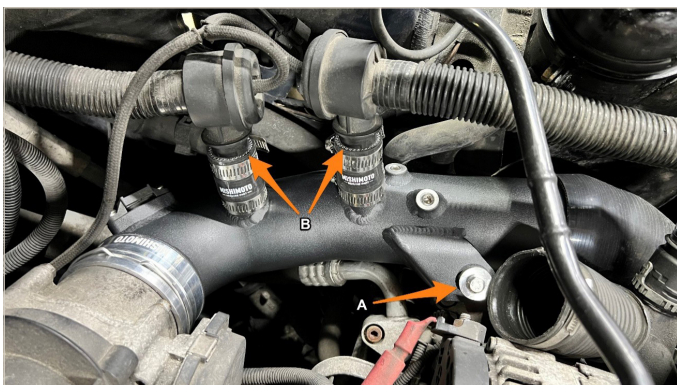

**8.** Reassemble the vehicle and test drive to check for boost leaks.

**Congratulations! You have finished your installation.**



## DISPOSAL INSTRUCTIONS

- › Do not dispose of any product as unsorted municipal waste. Use separate collection facilities. Contact your local authority for information regarding the collection systems available.
- › Never improperly dispose of any coolant, oil, or other chemicals.

## WARRANTY INFORMATION



- › All claims must be accompanied with a picture of the Mishimoto product showing the issue for which the claim is being submitted.
- › Mishimoto asks that the customer inspect their purchased item for any damage immediately upon arrival.
- › Any product deemed dead on arrival (DOA) must be claimed within 14 business days of delivery. Claims outside of this time frame will not be covered under the Mishimoto Lifetime Warranty.
- › This warranty does not include payment and/or reimbursement of the cost of labor in connection with the removal of any product returned pursuant to the warranty policy or in connection with the installation of any replacement items provided under the warranty policy.
- › Mishimoto has the right to refuse a claim at any time.

- › When Mishimoto accepts a claim, Mishimoto retains full discretion to choose if it will: (i) repair or replace purchaser's original Mishimoto product; (ii) replace purchaser's original Mishimoto product with the most current available model; or (iii) provide the purchaser with a gift card redeemable on [Mishimoto.com](http://Mishimoto.com) in the amount of the original purchase price of the original Mishimoto product. The provision of a replacement of a Mishimoto product is subject to availability and Mishimoto retains the right to substitute any warranty claim item with a comparable item or credit at any time.
- › If Mishimoto determines that it will provide a replacement item in connection with a claim under this warranty policy, and such item is out of stock, Mishimoto will place the customer on backorder and ship the replacement product to the purchaser once it becomes available.
- › Mishimoto is not liable for incorrect shipments in connection with a claim if a claim form is completed incorrectly, or if a model number is not included in a claim.
- › If you have a vehicle equipped with an automatic transmission, please make sure to specify this within the text box on the claim form. Mishimoto is not responsible for incorrect replacement shipments if transmission type is not indicated.



**WARNING**  
Cancer and  
Reproductive Harm  
[www.P65Warnings.ca.gov](http://www.P65Warnings.ca.gov)

This product can expose you to chemicals which are known to the state of California to cause cancer. For more information visit: [www.p65warnings.ca.gov](http://www.p65warnings.ca.gov)