

2012+ JEEP GRAND CHEROKEE SRT8

PERFORMANCE ALUMINUM RADIATOR

PARTS & INSTALLATION GUIDE



PARTS INCLUDED

- 1PC** Mishimoto Aluminum Radiator
- 7PC** Mounting Brackets
- 1PC** Mounting Hardware Pack

TOOLS NEEDED

- 8mm Socket
- 10mm Socket
- 13mm Socket
- 3mm Allen Key
- 4mm Allen Key
- 2.5mm Allen Key
- 1/4" Drive Ratchet & Extension
- Pop-Clip Removal Tool
- Pliers
- Plastic Rivet Tool

INSTALL TIME 4 Hours

INSTALL DIFFICULTY

DISCLAIMER

- Raise vehicle only on jack stands or on a vehicle lift.
- Allow vehicle to cool completely prior to attempting installation.
- Do not run the engine or drive the vehicle while overheating; serious damage can occur.
- Please dispose of any liquids properly.
- Mishimoto is not responsible for any vehicle damage or personal injury due to installation errors, misuse, or removal of Mishimoto products.
- Mishimoto suggests that a trained professional install all Mishimoto products.

INSTALL PROCEDURE

1. Remove the splash shield under the front end. (6x pop-clip, 2x 13mm bolts, 6x 8mm bolts, 4x 10mm bolts)



2. Drain the coolant via the drain plug. Release the cap to expedite the draining process.
3. Drill into the four rivets on each side. Then remove them and the plastic trim pieces from the wheel well. (8x plastic rivets)



4. Remove the bolts that secure the wheel well liners. (2x 10mm bolts)
5. Pull back the liners and disconnect all the electrical harnesses. For the harness shown below, disconnect the sensor right away or when the bumper is removed. It may be easier during the bumper removal.



6. Disengage the front bumper tabs. Remove the bumper from the vehicle.
7. Remove the clips that secure the engine bay trim panels. (13x pop-clips)

CONTINUED ON FOLLOWING PAGE

01

2012+ JEEP GRAND CHEROKEE SRT8 PERFORMANCE ALUMINUM RADIATOR INSTALLATION GUIDE



8. Remove the grille from the front of the vehicle. (2x 10mm bolts)
9. Remove the bolts and clip that secure the overflow and washer fluid tanks. (2x 10mm bolt, 1x pop-clip)

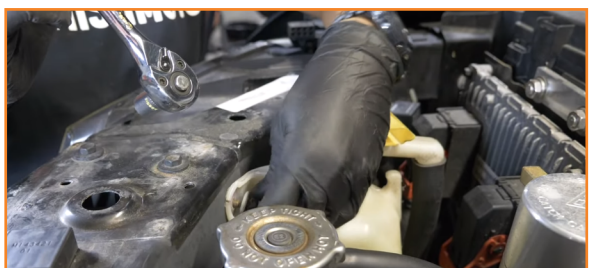

10. Remove the bolt that secures the AC line bracket. (1x 10mm bolt)



11. Disconnect the hood latch electrical harness at the front. Release its wiring from the radiator support. (5x pop-clips)
12. Remove the two horns. (2x 10mm bolts)
13. Separate the hood latch and let it rest in place.
14. Disconnect the ambient temperature sensor, and then detach the shrouding at the sides of the radiator.



15. Remove the bolts along the support bar, and then remove the radiator support. (7x 10mm bolts, 2x 13mm bolts)



16. Separate the hose attached to the fan shroud.
17. Compress the clamps on each end of the upper radiator hose to slide the hose ends off the ports. (2x spring clamp)



18. Compress the clamp on the lower radiator hose where it's connected to the radiator. Slide the hose off the radiator. Have a bucket prepared to catch any residual fluid. (1x spring clamp)
19. Unclip the power steering cooler lines from the radiator.

CONTINUED ON FOLLOWING PAGE

02

2012+ JEEP GRAND CHEROKEE SRT8 PERFORMANCE ALUMINUM RADIATOR INSTALLATION GUIDE



20. Separate the overflow hose from the radiator.



21. Lift the stock radiator out of the engine bay.
22. Transfer the lower grommets on the stock radiator to the Mishimoto radiator. The upper ones will be relocated later.
23. Install the Mishimoto radiator. Ensure that the lower grommets are properly seated.
24. Secure the AC condenser to the radiator. The longer M6 bolt belongs on the passenger side. (2x 4mm Allen bolts, 2x locking washers, 2x flat washers)

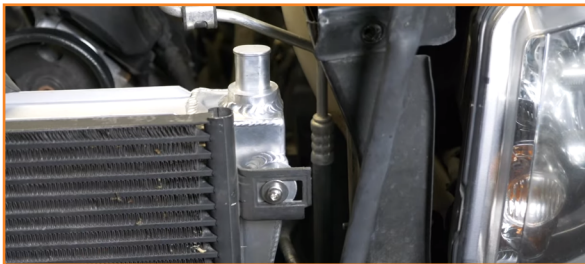

25. Use the wider set of brackets in your kit to secure the AC condenser to the bottom of the radiator on the passenger side. At the end of this guide, there is an additional illustration showing the correct bracket positions. (2x 3mm M5 bolts, 2x smaller spring washers, 2x smaller flat washers)



26. Use the thinner set of brackets to secure the AC condenser to the bottom of the radiator on the driver side. Use the illustration at the end for reference. (2x 3mm M5 bolts, 2x smaller spring washers, 2x smaller flat washers)
27. Reinstall the fan shroud behind the radiator.
28. Place the upper grommets on the radiator.
29. Install the brackets that secure the fan shroud to the radiator. (2x 3mm M4 bolt)



30. Reconnect the fan shroud electrical harness.
31. Secure the lower fan shroud bracket. (1x 10mm bolt)
32. Secure the power steering cooler lines.



33. Reattach the lower radiator hose. (1x spring clamp)
34. Make sure the drain plug on the radiator is tight.
35. Reinstall the overflow hose.
36. Reinstall the upper radiator hose and attach it to the fan shroud. (2x spring clamps)
37. Reinstall the upper support bar. (8x 10mm bolts)
38. Slide the radiator cover between the radiator and upper support bar. Clip it back in place.

CONTINUED ON FOLLOWING PAGE

03

2012+ JEEP GRAND CHEROKEE SRT8 PERFORMANCE ALUMINUM RADIATOR INSTALLATION GUIDE



39. Secure the washer fluid reservoir tank to the radiator support. (1x pop-clip)
40. Secure the AC line bracket. (1x 10mm bolt)
41. Reattach the coolant overflow tank. (2x 8mm bolts)
42. Reinstall the shrouding around the sides of the radiator.
43. Reconnect the surrounding electrical harnesses.
44. Reinstall the two horns. (2x 10mm bolts, 4x pop-clips)
45. Reinstall the hood latch to the support bar. (2x 8mm bolts)
46. Secure the bars to the upper support. (2x 13mm bolts)
47. Reconnect the hood latch sensor.
48. Refill the coolant to the proper level.
49. Reinstall the grille. (2x 10mm bolts)
50. Reinstall the engine bay trim panels. (13x pop-clips)
51. Reinstall the bumper and reconnect the electrical harnesses within the wheel well.
52. Reinstall the splash shield. (6x pop-clip, 2x 13mm bolts, 6x 8mm bolts, 4x 10mm bolts)
53. Secure the bumper to the fender. (2x 10mm bolts)
54. Secure the wheel well liners to the bumper. (8x plastic rivets)



Below are two illustrations on how to position the brackets when installing the Mishimoto radiator.

LOWER

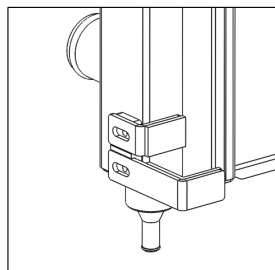

Install the wider 3/4" (19mm) set of L brackets on the driver's side of the radiator

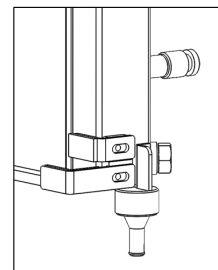

Install the narrower 5/8" (16mm) set of L brackets on the passenger side of the radiator.

UPPER

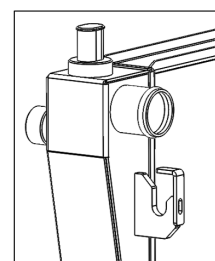
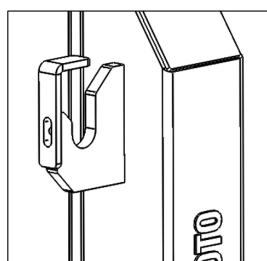

Congratulations! You have finished installing the Mishimoto 2012+ Jeep Grand Cherokee SRT8 Performance Aluminum Radiator.